



# ASSEMBLY OF TABIHAUS® PANELS

## INSTALLATION ON PITCHED ROOFS

### NECESARY TOOLS

- Circular saw with cut-off saw and guide
- 600ml silicone gun (pneumatic recommended)
- Screwdriver with depth stop
- Widia disc
- Cutter

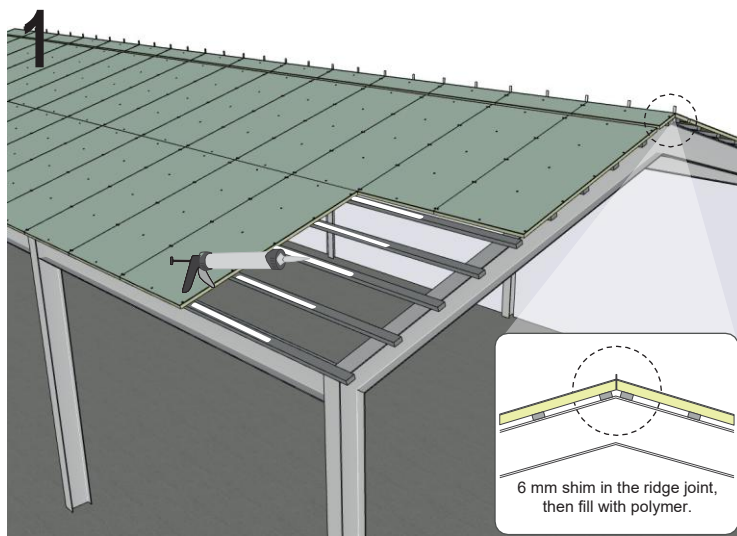

Apply a bead of polymer to the ENTIRE support area (metal or wooden profiles). Place a 6 mm shim in the ridge joint, then fill with polymer. Do not apply only for points.

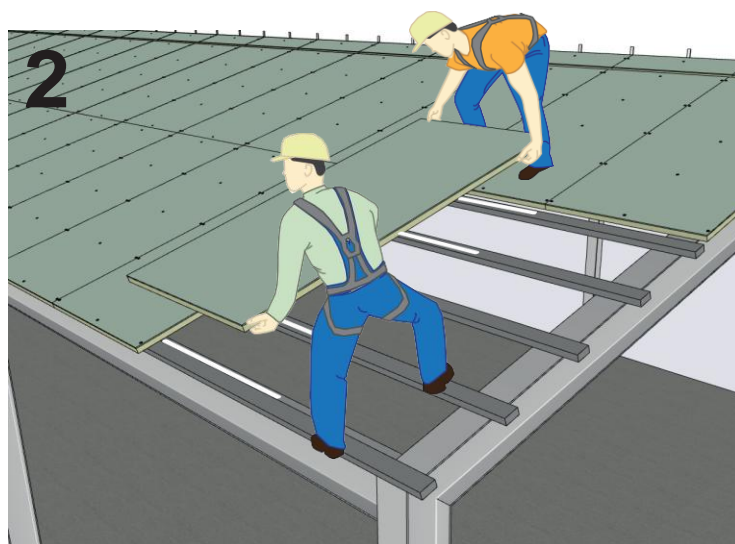

With the help of a partner, place the panel in the desired location.

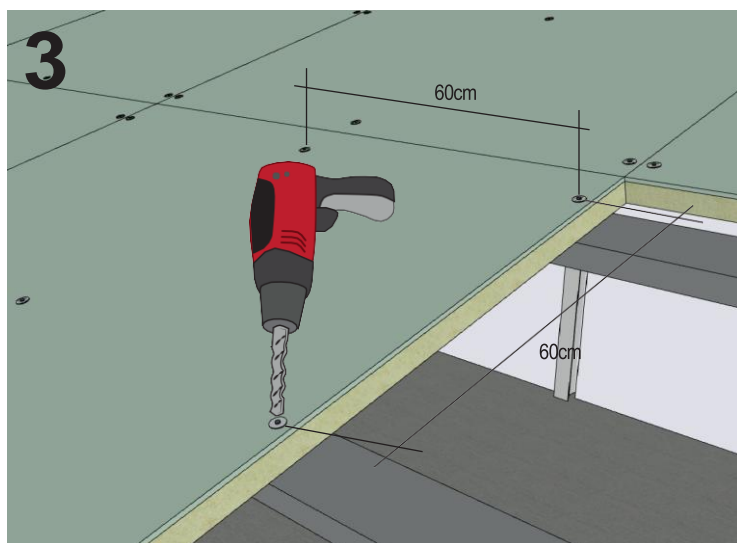

Screw the panel, with a distance of at least 1 cm from the end of the panel. Each screw must be screwed 60 cm apart, creating an arrangement that covers the entire surface of the panels. Minimum 4 screws/m<sup>2</sup>.

#### Take note

Subsequently, waterproof with any technique.

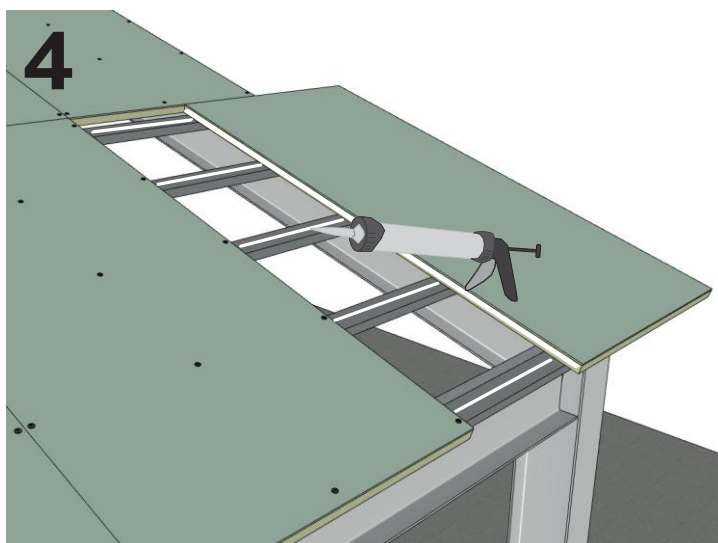

For the next panel, apply a bead of polymer around the perimeter of the panel to be installed following the line of the panel with the XPS and on the supporting structure (as shown in point 1). Remove by hand if excess polymer has come out at the joint. This will seal the joint between the installed panel and the next panel.